



How to use VPN in windows phone 8.1

Manual Setup

To set up a VPN profile manually on a Windows Phone 8.1 device:

1. Go to **Settings**. Select **VPN**. Turn on the **VPN status**. Select + to add/create a new profile.



2. Enter the server name or IP address **(172.10.100.1)**. Select **IKEv2**. To utilize SSL-VPN, select the link shown and download a third-party plugin.
3. For a password-based VPN, select **user name+password**. Enter the necessary details. Toggle the desired settings. To input more details, select **Advanced**. Select **Save**.

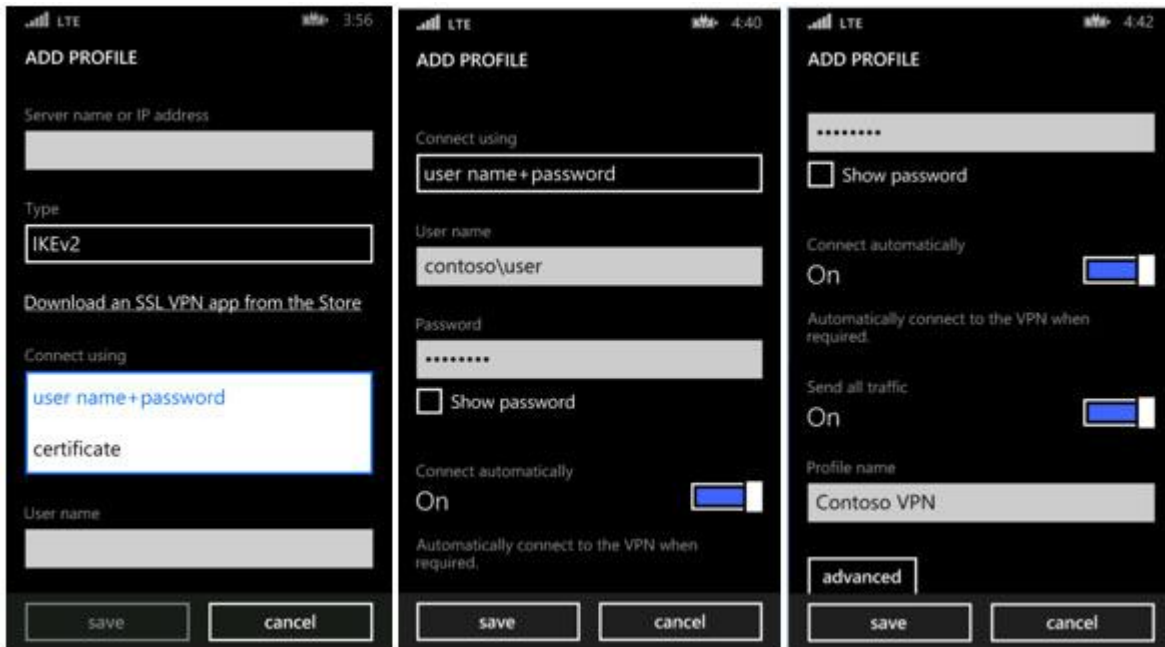

4. For a certificate-based VPN, select **certificate**. Choose the desired certificate. Toggle the desired settings. Enter the necessary details. To view the selected certificate details, select **details**.

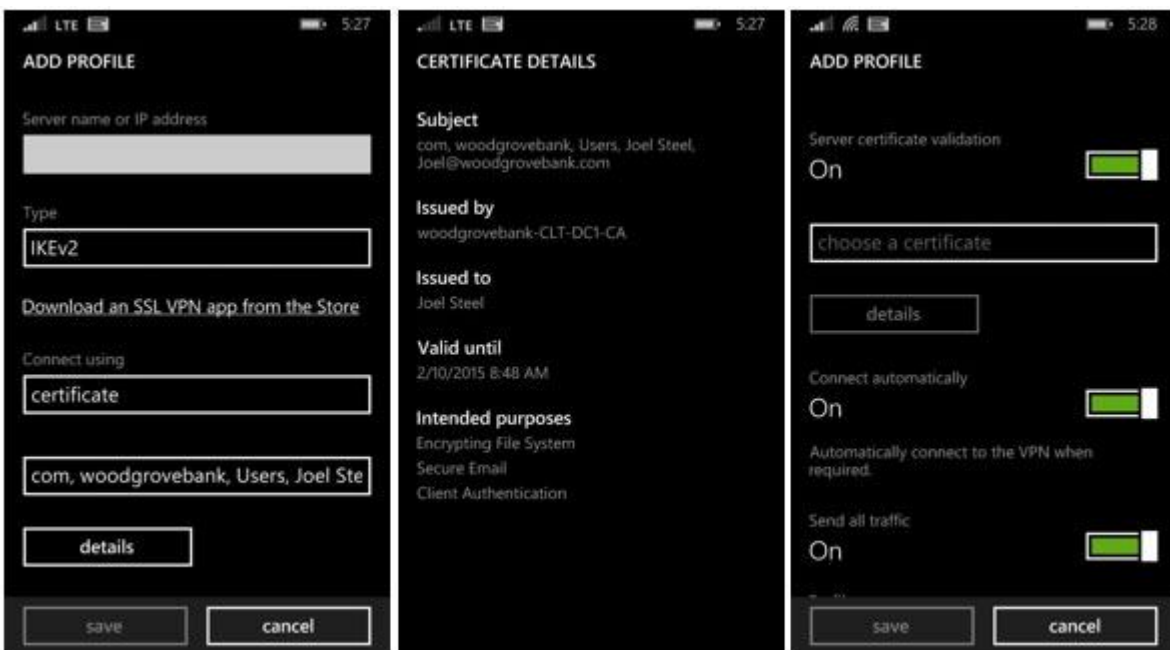



5. When setting up a certificate-based VPN, the first certificate that is selected under **Connect** is used for establishing the VPN connection.
6. If the **Server certificate validation option** is enabled, an option will be provided to select another certificate. This certificate will be used for the VPN authentication process after the connection has been established.
7. To input more details, select **Advanced**. Select **Save**. The automatic VPN profile has now been created. To make changes or view details on the profile, click and hold the profile. To switch to a manual profile, select **Switch to Manual**.

